

# CERTIFICATE OF LOCATION OF GOVERNMENT CORNER

NORTHEAST Corner of Section 8, Township 107, Range 39, 5th P.M.

STATE OF MINNESOTA, County of MURRAY

At the corner location shown on the sketch:

On DEC. 24/1991 found a see back of sheet  
DATE

left monument as found,  lowered monument,  removed monument (explain)

On DEC. 24/1991 placed a 5/8" rerod with seal at road surface  
DATE

SKETCH OF REFERENCE TIES

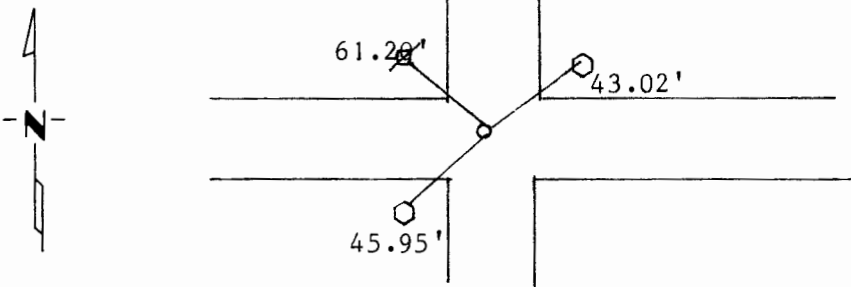

Nail and seal in power pole NE. 61.20'  
 Nail and seal in stop sign post NW. 43.05'  
 Nail and seal in stop sign post SE. 45.95'

Statement of evidence relative to this corner location is on back of page.

I hereby certify that this document and the data contained herein was prepared by me or under my direct supervision.

Regis E. Mooney JAN 13, 1992  
SIGNATURE DATE

Registration No. 11943

Land Surveyor,  Professional Engineer

County Surveyor,  County Engineer

## OFFICE OF THE COUNTY RECORDER

County of \_\_\_\_\_

I hereby certify that this document was filed in the Co. Recorders office at \_\_\_\_\_ .M. on the \_\_\_\_\_ day of \_\_\_\_\_ A.D., 19 \_\_\_\_

County Recorder \_\_\_\_\_

By \_\_\_\_\_, Deputy

DOCUMENT NO. \_\_\_\_\_

Statement of Evidence:

Original survey done in Aug.9--Sept.2, 1861 by Lewis Brochman,  
set pit and mound.

Nothing else ways recorded for the corner.

Murray County Highway Department dug with a back hoe in 1978 and  
did not find any thing.

December 24, 1991 I set a 5/8 inch rerod with seal by existing  
evidence I did not redig in the asphalt road. I set the Quarter  
corner north of this corner everything loods good with existing  
fences and roads.